



MODEL 73010

For 1 or 2 players / Ages 8 and up  
P/N 82370200 Rev.E

## INSTRUCTION MANUAL

***Get ready, it's Poker at its best! LoBall,  
Deuces, and Draw Poker all in one game!***

### HOW TO PLAY:

- Turn on the game by pressing the ON/DEAL/DRAW button.
- Select the game you wish to play with the HOLD/GAME button while "Game Over" is flashing.
- Press the ON/DEAL/DRAW or MAX BET buttons to deal your first set of cards.
- Select the cards you wish to hold by using the HOLD buttons.
- Press ON/DEAL/DRAW to receive your replacement cards.
- When playing Deuces, the "2" card (or "deuce") of any suit is considered wild and can assume any other card.
- In LoBall, the lowest possible hands are winners and Aces are always low. A single pair or a card above 8 automatically lose, expect with 2 pairs.
- A bonus of 100 points is awarded for 3 consecutive winning hands.

### BUTTON FUNCTIONS:

#### On/Deal/Draw

- Press to Turn On the game. The game turns itself off after sitting idle for one minute.
- Press and hold down this button for a BET of 10, 20, 30, 40, or 50 points. The cards are dealt when the button is released.
- After holding the cards you want to keep, press this button again to *DRAW* you replacement cards.

#### Hold

Press the Hold button below each card you want to keep. Press again to delete the hold on that card.

#### Hold/Game

Press this button while "Game Over" is flashing to switch between Draw, LoBall, and Deuces Poker. The game mode is shown in the top left corner of the display.

#### Ride

After winning a hand, up to 500 points, are stored in the "Let it Ride"(LIR) area of the display. To bet this entire amount press this button.

#### Max Bet

This button can be pressed to automatically bet 50 points.

#### Player

Press and hold this button while "Game Over" to select one player or two players game.

#### Sound

Press to turn sound on and off.

#### Score

Your SCORE is automatically calculated after each hand and when betting. "Win" will flash and winning melody will play for each successful hand. The scoring table (based on a 50 point bet) is printed at the back of game. Then press the ON/DEAL/DRAW button to shuffle and deal the cards.

### Parlay Bet Payoffs

When betting with the points stored in the Parlay Bet/LIR area, if a winning hand is achieved, the payoff is calculated as follows:

$$\text{Parlay Bet} / \text{LIR Amount} \times \text{LIR Factor} = \text{Payoff}$$

The LIR Factor for each winning hand is listed below:

### Draw Poker

Hand	LIR Factor	Hand	LIR Factor
Royal Flush	250	5 4 3 2 A -Flush	500
Straight Flush	50	5 4 3 2 A	30
4 of a Kind	25	6 4 3 2 A	25
Full House	8	6 5 x x x	12
Flush	5	7 4 x x x	8
Straight	4	7 5 x x x	5
3 of a Kind	3	7 6 x x x	3
2 Pairs	2	8 High	2
Pair of Jacks or better	1	2 Pairs	1

### LoBall Poker

### Deuces Poker

Hand	LIR Factor	Hand	LIR Factor
Royal Flush	300	4 of a Kind	4
4 Two's	200	Full House	4
Royal Flush w/ 2's	20	Flush	3
5 of a Kind	10	Straight	2
Straight Flush	8	3 of a Kind	1

## BATTERY INSTALLATION:

This game is powered by two (2) AAA (LR03) batteries.

- Remove the battery cover: Press a coin down into the slot. Then slide the battery cover off, as shown.
- Insert two AAA batteries (we recommend alkaline) as indicated inside the battery compartment.
- Replace the battery compartment door.

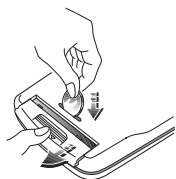

## ADULT SUPERVISION IS RECOMMENDED WHEN CHANGING BATTERIES.

## CAUTION:

- As with all small batteries, the batteries used with this game should be kept away from small children who might still put things in their mouths. If a battery is swallowed, consult a physician immediately.
- Be sure you insert the battery correctly and always follow the game and battery manufacturer's instructions.
- Do not dispose of batteries in fire.
- Batteries might leak if improperly installed, or explode if recharged, disassembled or heated.
- Sometimes, a build-up of static electricity (from carpets, etc) may cause the game to stop working. Just reset the game, and it will work again.
- The unit may malfunction when there is a radio interference on the power line. The unit will revert to normal operation when the interference stops.
- Under the environment with radio frequency interference, the sample may malfunction and require user to reset the sample.

## MAINTENANCE:

- Handle this game carefully.
- Store this game away from dusty or dirty areas.
- Keep this game away from moisture or extreme temperature.
- Do not disassemble this game. If a problem occurs, remove and replace the batteries to reset the computer or try new batteries. If problems persist, consult the Warranty information located at the end of this Instruction Manual.
- Use only the recommended battery type.
- Do not mix old and new batteries.
- Do not mix alkaline, standard (carbon-zinc) or rechargeable (nickel-cadmium) batteries.
- Do not use rechargeable batteries.
- Do not attempt to recharge non-rechargeable batteries.
- Remove any exhausted batteries from the device.
- Do not short-circuit the supply terminals.
- Insert batteries with the correct polarity.

## Please retain this for future reference.

## 90-DAY LIMITED WARRANTY

(This product warranty is valid in the United States and Canada only)

Radica Games Limited warrants this product for a period of 90 days from the original purchase date under normal use against defective workmanship and materials (batteries excluded). This warranty does not cover damage resulting from accident, unreasonable use, negligence, improper service or other causes not arising out of defects in material or workmanship. Radica Games Limited will not be liable for any costs incurred due to loss of use of this product or other incidental or consequential costs, expenses or damages incurred by the purchaser. Some states do not allow the exclusion or limitation of incidental or consequential damages, so the above limitations may not apply to you. This warranty gives you specific legal rights and you may also have other legal rights, which vary from state to state.

During this 90-day warranty period, the game will either be repaired or replaced (at our option) without charge to the purchaser when returned prepaid with proof of date of purchase to: **Radica USA, Ltd., 13628-A Beta Road, Dallas, Texas 75244, USA.** Please remove the batteries and wrap the unit carefully before shipping. Please include a brief description of the problem along with your return address and mail it postage prepaid.

**IMPORTANT:** Before returning the unit for repair, test it with fresh alkaline batteries. Even new batteries may be defective or weak and low battery power is a frequent cause of unsatisfactory operation.

**RADICA®**  
BIG SCREEN POKER IS A  
REGISTERED TRADEMARK OF  
RADICA GAMES LTD.  
© 2002 RADICA GAMES LTD.  
PRODUCT SHAPE™  
ALL RIGHTS RESERVED

